

Name: Barry Baker

Date:

Event: Top Notch Rd. 3 OCRC

Track Conditions: Outdoor Indoor Wet Dry High Bite Low Bite
 Rough Smooth Hard Packed Loose/Loamy Blue Groove

Bumpsteer/Ackerman/Servo Saver:



Front End:

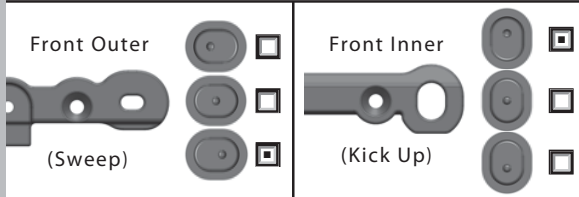
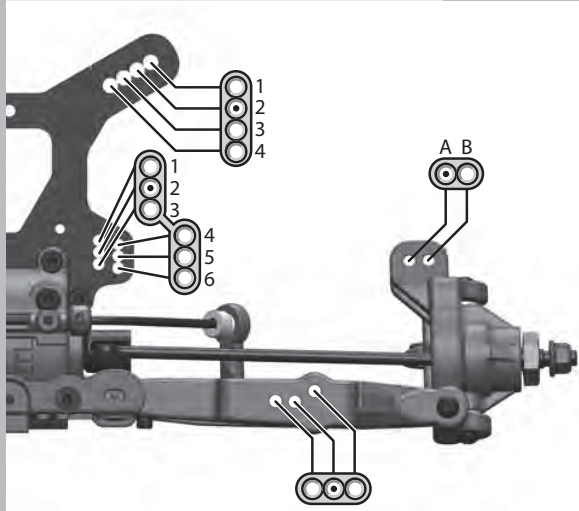

Rear End:

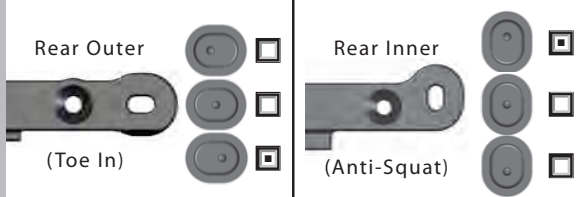
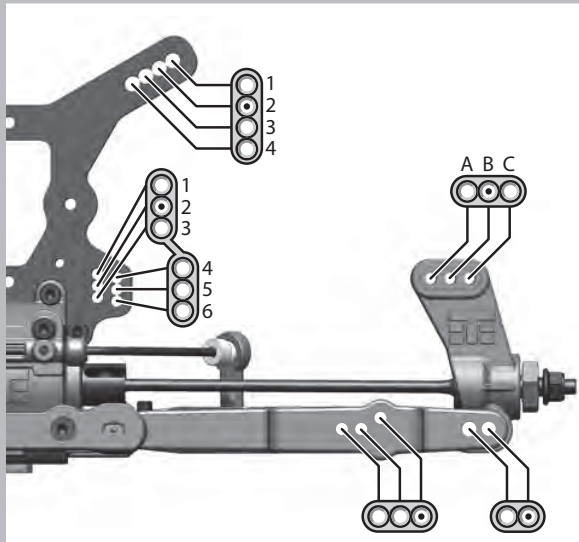

Suspension:

	FRONT	REAR
RIDE HEIGHT	26	26
CAMBER	-1.5	-1.5
TOE (in/out)	1out	3.5inner 1 outer
SWAY BAR	2.4	2.6
SHOCK LENGTH (DROOP)	101	119

Body/Mounts:

BODY MAKE: J Concepts Hi-Flow

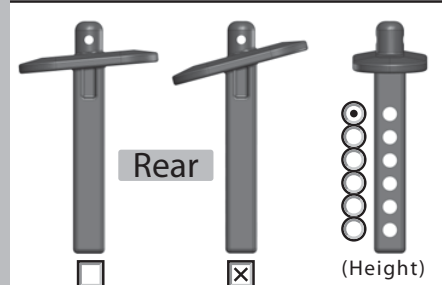
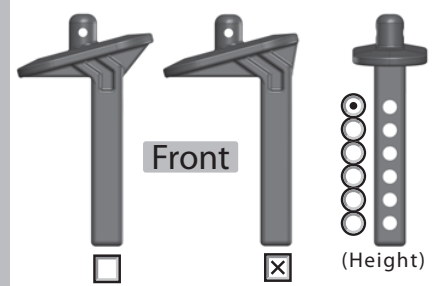

Wheelbase:

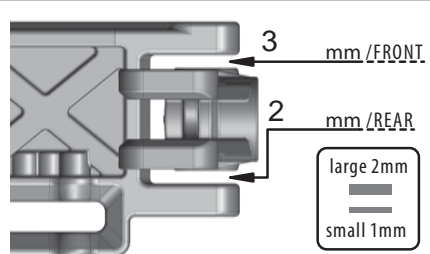

Notes:

Optional Air Control Side Panels Installed.

Shocks:

	FRONT	REAR
OIL	37.5losi	32.5losi
PISTON	1.2x10hole	1.2x10hole
SPRING	Kit	Kit
REBOUND	none %	none %
STD/EMUL/VENT	std	std

Tires / Wheels:

	FRONT	REAR
BRAND/TREAD	AKA Wishbone	AKA Wishbone
COMPOUND	Clay	Clay
INSERT	AKA Red	AKA Red
WHEEL	AKA scte	AKA scte

NOTES:

Differential Oil:

	FRONT	CENTER	REAR
	7k	10k	5k

Electronics:

ESC:	LRP SXX TC spec Ver.2
Battery:	ProTek 70C 6400
Motor:	LRP Dynamic 10 4800
Radio:	Airtronics M11X
Servo:	ProTek

Drivetrain:

SPUR GEAR	Metal <input type="checkbox"/> Composite <input checked="" type="checkbox"/>
Traktion Drive	<input type="checkbox"/> Elektri-Clutch <input type="checkbox"/> Pinion <input checked="" type="checkbox"/>
PINION SIZE	15 (teeth)
Mechanical Brakes	<input type="checkbox"/> Motor Brakes <input checked="" type="checkbox"/>

Chassis Braces:

Front <input checked="" type="checkbox"/> Middle <input type="checkbox"/> Rear <input type="checkbox"/>
(front brace is always recommended)