

# TKR5447B

## COMPLETE CENTER DIFFERENTIAL

### (OVERVIEW)

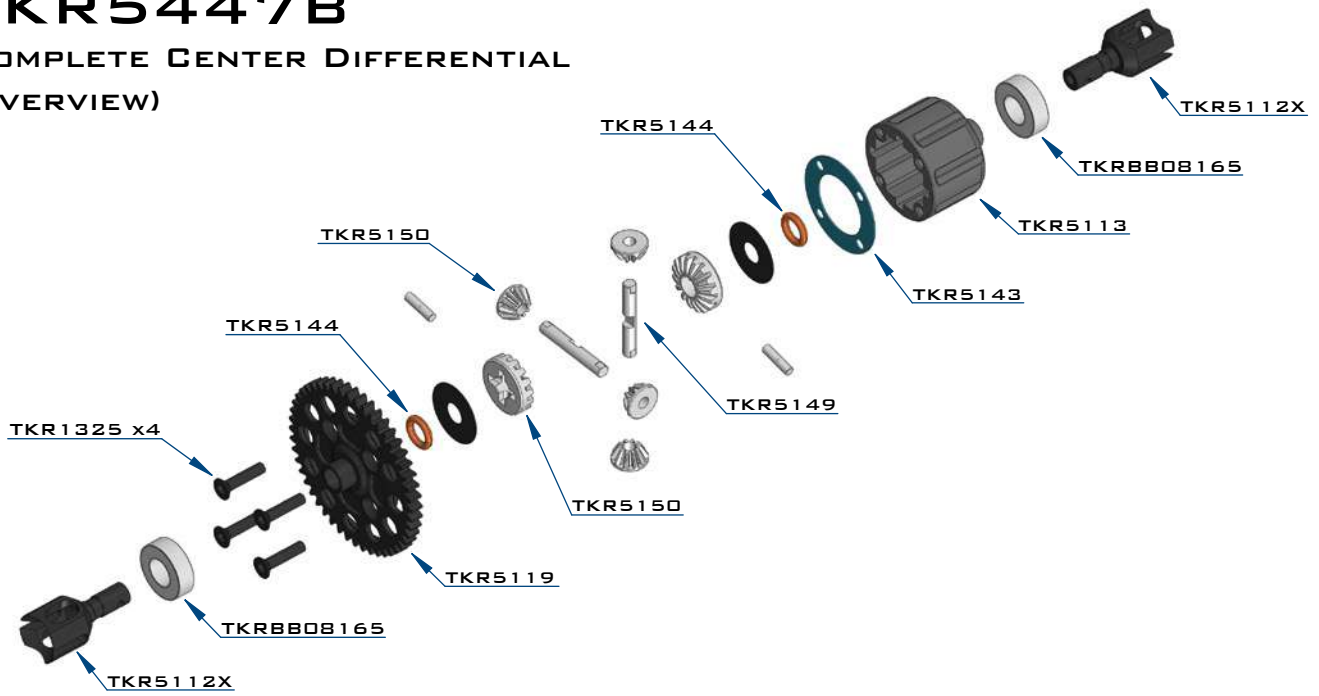

#### STEP 1

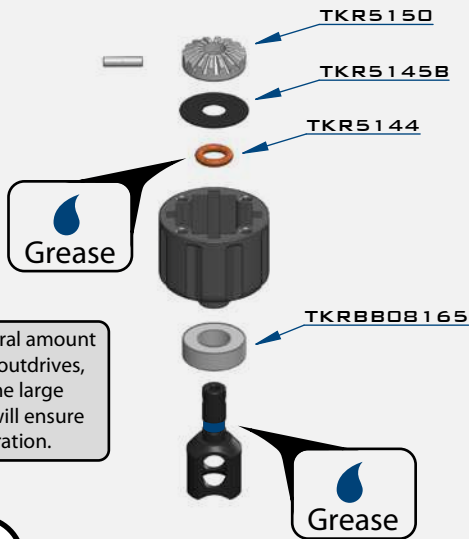

Note: Apply a liberal amount of grease to the outdrives, o-rings, and the large diff shims. This will ensure smooth operation.

#### STEP 2

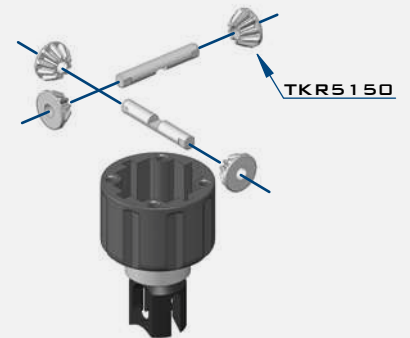

#### STEP 4

Note: Apply a liberal amount of grease in the areas between the shims and o-rings, as well as around the outdrive and both sides of the seal.

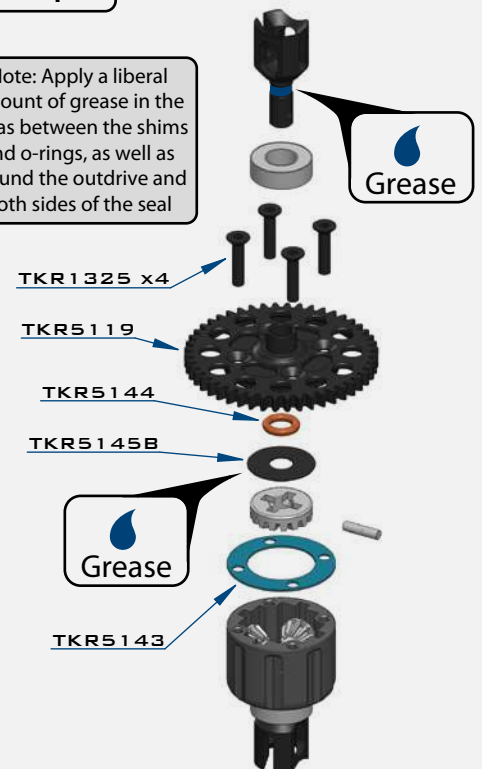

#### STEP 3

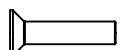

Fill oil to 1mm below full

 x4  
TKR1325  
M3X14MM FLAT HEAD SCREW

 x2  
TKR5144  
DIFFERENTIAL O-RINGS

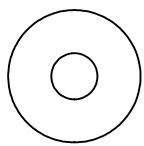
 x2  
TKR5145B  
DIFFERENTIAL SHIMS (6X17MM)

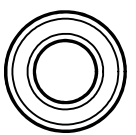
 x2  
TKRBB08165  
BALL BEARING(8X16X5MM)